

20 Gabor Close, Rugby, CV21 1XQ



£975 Per Month

Nestled in the charming area of Gabor Close, Rugby, this delightful house presents an excellent opportunity for those seeking a comfortable and inviting home. The property boasts a prime location, offering easy access to local amenities, schools, and transport links, making it ideal for families and professionals alike.

As you step inside, you will be greeted by a warm and welcoming atmosphere. The spacious layout provides ample room for both relaxation and entertaining. Natural light floods the living areas, creating a bright and airy environment that enhances the overall appeal of the home.

The kitchen is well-appointed, providing a functional space for culinary enthusiasts to create delicious meals. With sufficient storage and work surfaces, it is both practical and inviting. The adjoining dining area is perfect for family gatherings or intimate dinners with friends.

The bedrooms are generously sized, offering a peaceful retreat at the end of the day. Each room is designed with comfort in mind, ensuring a restful night's sleep. The bathroom is modern and well-maintained, featuring all the necessary amenities for your daily routine.

Service without compromise

Entrance Hall



Enter via double glaze UPVC front door. Stairs comprising to first floor. Door leading to-

Lounge



Double glaze UPVC window to front. Radiator. Door leading to -



Kitchen/Diner



Double glaze UPVC window and sliding patio doors to rear. Range of fitted base and wall units.



Bedroom Two



Bedroom One



Double glaze UPVC window to the front, Radiator.



Double glaze UPVC window to rear, Radiator.





Bathroom



Parking Area



Rear Garden



Outside space

To the front there is ample off road parking. To the rear is an attractive garden laid with lawn and a slabbed patio area.

Rear Aspect



Additional Information

Council tax band B

Holding Deposit based on £975 rent per calendar month amounting to £225

Damage deposit based on £975 per calendar month amounting to £1,125

Floor Plan

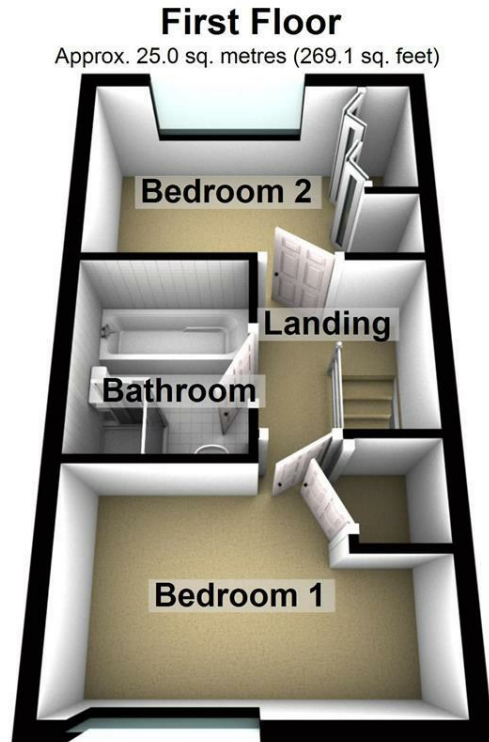
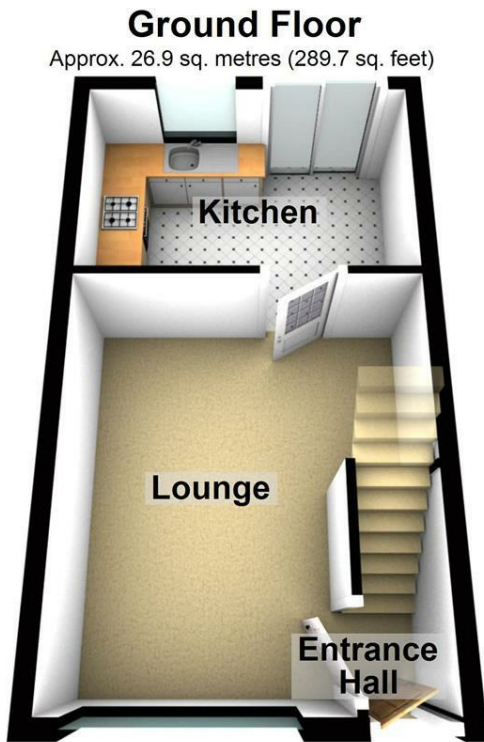

Total area: approx. 51.9 sq. metres (558.8 sq. feet)

Area Map

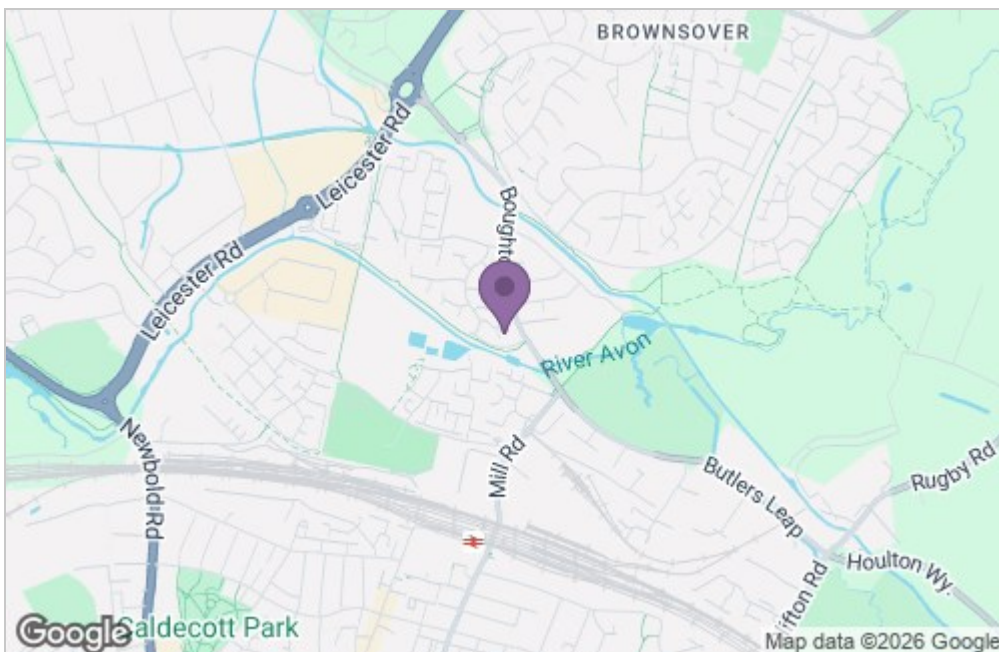

Energy Efficiency Graph

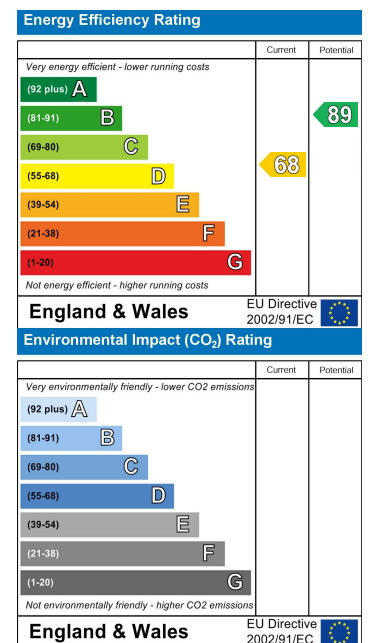

Service without compromise